

## OB35X90P



### OVAL SUCCTION CUP WITH SHORT BELLOWS

- Suitable for level adjustment. Can handle objects with height differences and varying shapes, for example embossed or corrugated plates.
- Lifting movement to separate small and thin objects.
- In the two coloured suction cup, the bellows and the sealing lip are of different hardnesses, which makes the suction cup strong and stable and, at the same time, soft and flexible.
- DURAFLEX® are suction cups manufactured in a specially developed material that features the elasticity of rubber and wear resistance of polyurethane. The material is mark-free.

### LIFTING FORCES & TECHNICAL DATA

Material	Lifting force vertical to the surface, N, at vacuum level			Lifting force parallel to the surface, N, at vacuum level			Volume cm <sup>3</sup>	Min. curve radius mm	Max. vertical movement mm	Weight rubber part g
	20 -kPa	60 -kPa	90 -kPa	20 -kPa	60 -kPa	90 -kPa				
PU60°	28	91	145	56	153	215	36	20.0	8.0	48
PU30°/60°	38	98	134	66	154	206	36	25.0	8.0	48

### MATERIAL SPECIFICATIONS

Material	Colour	Hardness, °Shore A	Temperature range, °C
Polyurethane, PU30	Yellow transparent	30	10–50
Polyurethane, PU60	Green transparent	60	10–50

### MATERIAL RESISTANCE

Wear resistance	Oil	Weather & ozone	Hydrolysis	Petrol	Concentrated acids	Ethanol	Methanol	Oxidation
Excellent	Excellent	Excellent	Fair**	Fair	Fair**	Fair	Poor	Poor

\*\*Please contact PIAB.

### ORDERING INFORMATION

	Complete suction cups	Art. No.
A	Suction cup OB35x90P Polyurethane 60, 3/8"NPSF female	0108672
B	Suction cup OB35x90P Polyurethane 60, thread insert G3/8" male, with mesh filter	0108673
A	Suction cup OB35x90P Polyurethane 30/60, 3/8"NPSF female	0109857
B	Suction cup OB35x90P Polyurethane 30/60, thread insert G3/8" male, with mesh filter	0109856

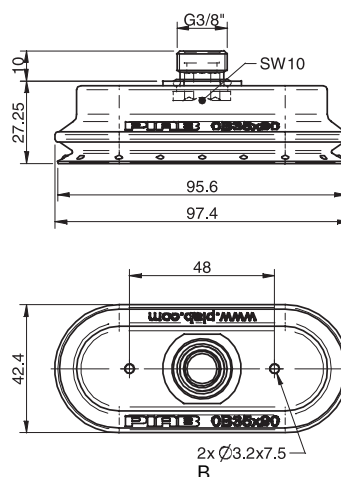
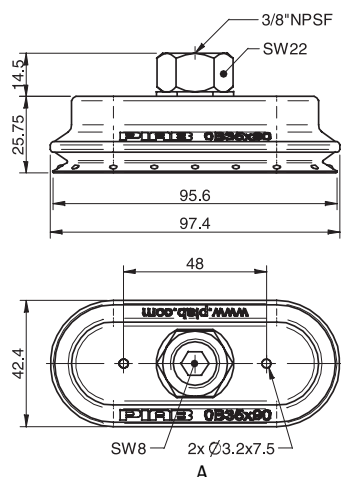

Rubber parts	Art. No.
Suction cup OB35x90P Polyurethane 60	0109912
Suction cup OB35x90P Polyurethane 30/60	0109913

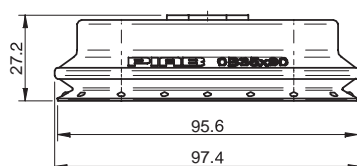

Fittings	Art. No.
Thread insert G3/8" male, with O-ring and mesh filter	0107148

## OB50X140P



### OVAL SUCTION CUP WITH SHORT BELLOWS

- Suitable for level adjustment. Can handle objects with height differences and varying shapes, for example embossed or corrugated plates.
- Lifting movement to separate small and thin objects.
- In the two coloured suction cup, the bellows and the sealing lip are of different hardnesses, which makes the suction cup strong and stable and, at the same time, soft and flexible.
- DURAFLEX® are suction cups manufactured in a specially developed material that features the elasticity of rubber and wear resistance of polyurethane. The material does not leave any marks on the objects handled.

### LIFTING FORCES & TECHNICAL DATA

Material	Lifting force vertical to the surface, N, at vacuum level			Lifting force parallel to the surface, N, at vacuum level			Volume cm <sup>3</sup>	Min. curve radius mm	Max. vertical movement mm	Weight rubber part g
	20 -kPa	60 -kPa	90 -kPa	20 -kPa	60 -kPa	90 -kPa				
PU60°	77	231	368	122	292	396	95	26	11.3	129
PU30°/60°	58	235	366	110	260	349	95	23.0	11.3	129

### MATERIAL SPECIFICATIONS

Material	Colour	Hardness °Shore A	Temperature range °C
Polyurethane, PU30	Yellow transparent	30	10–50
Polyurethane, PU60	Green transparent	60	10–50

### MATERIAL RESISTANCE

Wear resistance	Oil	Weather & ozone	Hydrolysis	Petrol	Concentrated acids	Ethanol	Methanol	Oxidation
Excellent	Excellent	Excellent	Fair**	Fair	Fair**	Fair	Poor	Poor

\*\*Please contact PIAB.

## ORDERING INFORMATION

	Complete suction cups	Art. No.
A	Suction cup OB50x140P Polyurethane 60, 3/8"NPSF female	0108674
B	Suction cup OB50x140P Polyurethane 60, thread insert G3/8" male, with mesh filter	0108675
A	Suction cup OB50x140P Polyurethane 30/60, 3/8"NPSF female	0109859
B	Suction cup OB50x140P Polyurethane 30/60, thread insert G3/8" male, with mesh filter	0109858

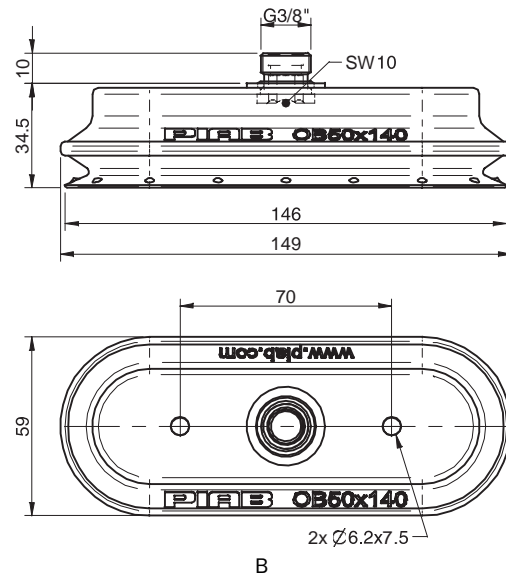
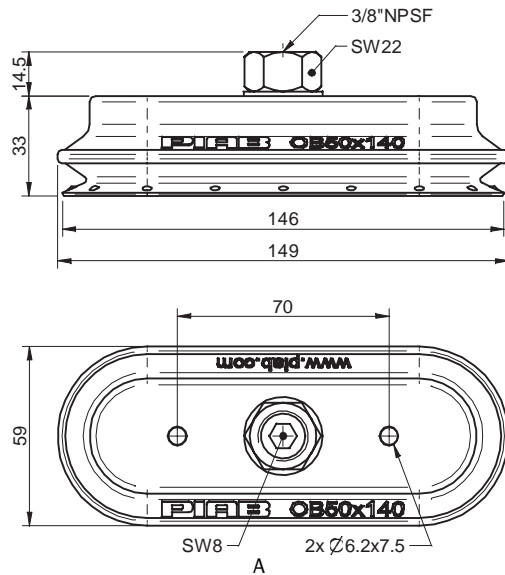

	Rubber parts	Art. No.
	Suction cup OB50x140P Polyurethane 60	0109914
	Suction cup OB50x140P Polyurethane 30/60	0109915

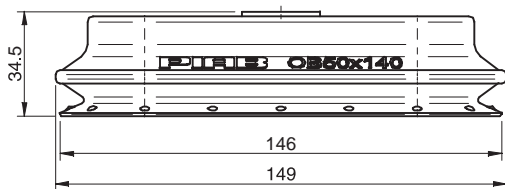

	Fittings	Art. No.
	Thread insert G3/8" male, with O-ring and mesh filter	0107148

## OB65X170P



### OVAL SUCTION CUP WITH SHORT BELLOWS

- Suitable for level adjustment. Can handle objects with height differences and varying shapes, for example embossed or corrugated plates.
- Lifting movement to separate small and thin objects.
- In the two coloured suction cup, the bellows and the sealing lip are of different hardnesses, which makes the suction cup strong and stable and, at the same time, soft and flexible.
- DURAFLEX® are suction cups manufactured in a specially developed material that features the elasticity of rubber and wear resistance of polyurethane. The material does not leave any marks on the objects handled.

### LIFTING FORCES & TECHNICAL DATA

Material	Lifting force vertical to the surface, N, at vacuum level			Lifting force parallel to the surface, N, at vacuum level			Volume cm <sup>3</sup>	Min. curve radius mm	Max. vertical movement mm	Weight rubber part g
	20 -kPa	60 -kPa	90 -kPa	20 -kPa	60 -kPa	90 -kPa				
PU60°	130	310	533	170	440	600	175	38	16.0	241
PU30°/60°	119	335	541	141	379	532	175	38	16.0	241

### MATERIAL SPECIFICATIONS

Material	Colour	Hardness °Shore A	Temperature range °C
Polyurethane, PU30	Yellow transparent	30	10–50
Polyurethane, PU60	Green transparent	60	10–50

### MATERIAL RESISTANCE

Wear resistance	Oil	Weather & ozone	Hydrolysis	Petrol	Concentrated acids	Ethanol	Methanol	Oxidation
Excellent	Excellent	Excellent	Fair**	Fair	Fair**	Fair	Poor	Poor

\*\*Please contact PIAB.

ORDERING INFORMATION

	Complete suction cups	Art. No.
A	Suction cup OB65x170P Polyurethane 60, 3/8"NPSF female	0108676
B	Suction cup OB65x170P Polyurethane 60, thread insert G3/8" male, with mesh filter	0108677
A	Suction cup OB65x170P Polyurethane 30/60, 3/8"NPSF female	0109861
B	Suction cup OB65x170P Polyurethane 30/60, thread insert G3/8" male, with mesh filter	0109860

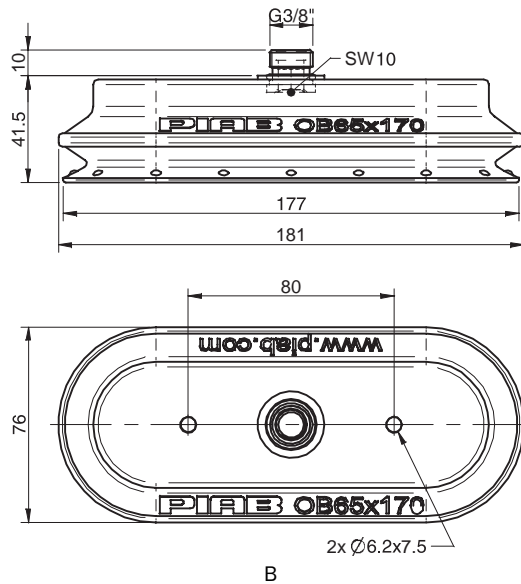
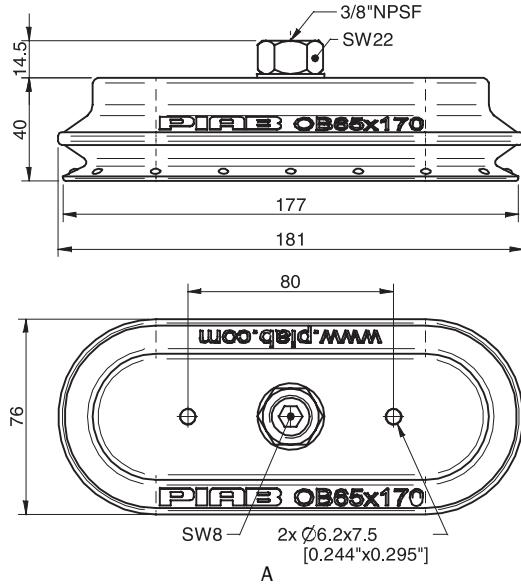

	Rubber parts	Art. No.
	Suction cup OB65x170P Polyurethane 60	0109916
	Suction cup OB65x170P Polyurethane 30/60	0109917

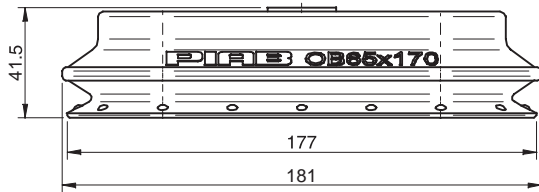

	Fittings	Art. No.
	Thread insert G3/8" male, with O-ring and mesh filter	0107148

## OBL40X90P



### OVAL SUCCTION CUP WITH 4 BELLOWS

- Suitable for long, narrow and bent surfaces, for example bottles, pipes or sharply bent sheet parts.
- Reinforcement plates gives stability to the suction cup.
- Available in a version with a valve that is activated when the bellows are compressed.
- DURAFLEX® suction cups manufactured in a specially developed material that features the elasticity of rubber and wear resistance of polyurethane. The material does not leave any marks on the objects handled.

### LIFTING FORCES & TECHNICAL DATA

Material	Lifting force vertical to the surface, N, at vacuum level			Lifting force parallel to the surface, N, at vacuum level			Volume cm <sup>3</sup>	Min. curve radius mm	Max. vertical movement mm	Weight rubber part g
	20 -kPa	60 -kPa	90 -kPa	20 -kPa	60 -kPa	90 -kPa				
PU60°	44	105	160	40	87	121	105	28	31	77
PU70°	49	117	178	45	97	135	105	28	31	77

### MATERIAL SPECIFICATIONS

Material	Colour	Hardness °Shore A	Temperature range °C
Polyurethane PU60	Green transparent	60	10-50
Polyurethane PU70	Black	70	10-50

### MATERIAL RESISTANCE

Wear resistance	Oil	Weather & ozone	Hydrolysis	Petrol	Concentrated acids	Ethanol	Methanol	Oxidation
Excellent	Excellent	Excellent	Fair**	Fair	Fair**	Fair	Poor	Poor

\*\*Please contact PIAB.

### ORDERING INFORMATION

	Complete suction cups	Art. No.
A	Suction cup OBL40x90P Polyurethane 60, with 3 reinforcement plates and load support	0106697
B	Suction cup OBL40x90P Polyurethane 60, with cone valve, 2 reinforcement plates and load support	0106698
A	Suction cup OBL40x90P Polyurethane 70, with 3 reinforcement plates and load support	0106694
B	Suction cup OBL40x90P Polyurethane 70, with cone valve, 2 reinforcement plates and load support	0104895

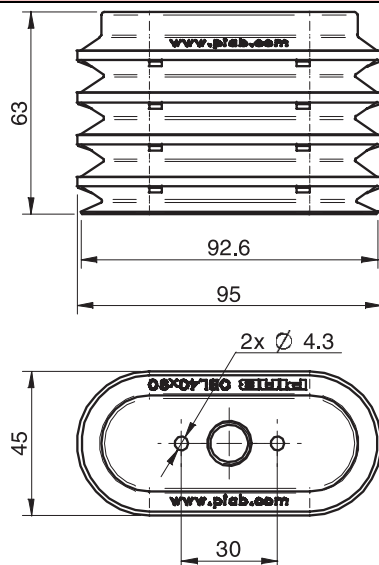

A

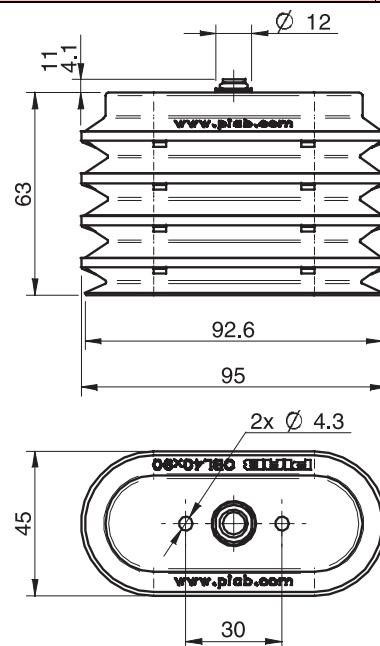

B

## OC60X140



### OVAL, CONCAVE SUCTION CUP

- Suitable for handling oblong objects with flat or curved surface.
- Good stability and little inherent movement.
- Thick, durable lip.

### LIFTING FORCES & TECHNICAL DATA

Lifting force vertical to the surface, N, at vacuum level			Lifting force parallel to the surface, N, at vacuum level			Volume	Min. curve radius	Max. vertical movement	Weight with fitting
20 -kPa	60 -kPa	90 -kPa	20 -kPa	60 -kPa	90 -kPa	cm <sup>3</sup>	mm	mm	g
132	373	520	186	373	510	52	200	7.5	160

### MATERIAL SPECIFICATIONS

Material	Colour	Hardness °Shore A	Temperature range °C
Nitrile, NBR	Black	50	-20-100

### MATERIAL RESISTANCE

Wear resistance	Oil	Weather & Ozone	Hydrolysis	Petrol	Concentrated acids	Alcohol	Oxidation
Excellent	Excellent	Fair	Good	Good	Fair	Good	Good

### ORDERING INFORMATION

Complete suction cups	Art. No.
Suction cup OC60x140 Nitrile, G3/8" female	3350011

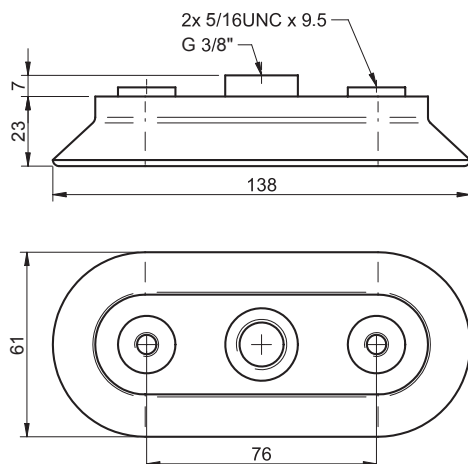

## OC35X90P



### OVAL, CONCAVE SUCTION CUP

- Suitable for oblong objects with slightly domed or flat and oily surfaces, such as those encountered in body parts in the automotive industry.
- DURAFLEX® suction cups manufactured in a specially developed material that features the elasticity of rubber and wear resistance of polyurethane. The material does not leave any marks on the objects handled.
- Fitting option, male G3/8", with a swivel function prior to the locking operation, for easy positioning of the oval cup.

### LIFTING FORCES & TECHNICAL DATA

Material	Lifting force vertical to the surface, N, at vacuum level			Lifting force parallel to the surface, N, at vacuum level			Volume cm <sup>3</sup>	Min. curve radius mm	Max. vertical movement mm	Weight with fitting g	Weight with adj. thread insert g
	20 -kPa	60 -kPa	90 -kPa	20 -kPa	60 -kPa	90 -kPa					
PU40°	49	117	171	53	112	147	20.0	—	3.0	27	40
PU60°	49	132	171	68	161	206	20.0	—	3.0	27	40

### MATERIAL SPECIFICATIONS

Material	Colour	Hardness °Shore A	Temperature range °C
Polyurethane, PU40	Red transparent	40	10–50
Polyurethane, PU60	Green transparent	60	10–50

### MATERIAL RESISTANCE

Wear resistance	Oil	Weather & ozone	Hydrolysis	Petrol	Concentrated acids	Ethanol	Methanol	Oxidation
Excellent	Excellent	Excellent	Fair**	Fair	Fair**	Fair	Poor	Poor

\*\*Please contact PIAB.



ORDERING INFORMATION

	Complete suction cups	Art. No.
A	Suction cup OC35x90P Polyurethane 40, G3/8" female	0102374
A	Suction cup OC35x90P Polyurethane 40, 3/8"NPSF female	0102375
A	Suction cup OC35x90P Polyurethane 60, G3/8" female	0103305
A	Suction cup OC35x90P Polyurethane 60, 3/8"NPSF female	0103303
B	Suction cup OC35x90P Polyurethane 40, adjustable thread insert G3/8" male with mesh filter	0115307
B	Suction cup OC35x90P Polyurethane 60, adjustable thread insert G3/8" male with mesh filter	0115313

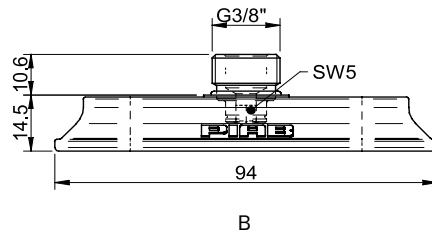
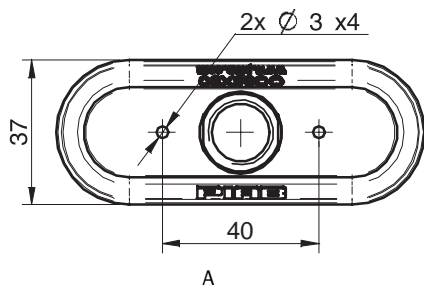
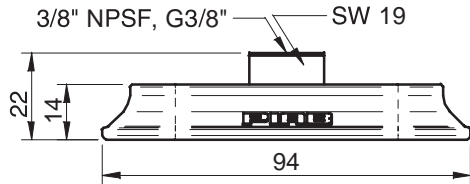

Rubber parts	Art. No.
Suction cup OC35x90P Polyurethane 40	0115306
Suction cup OC35x90P Polyurethane 60	0115312

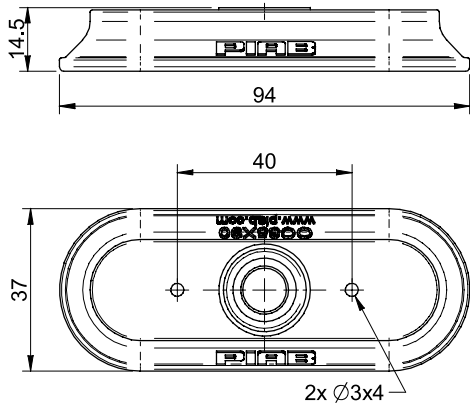

## OF10X30P



### FLAT, OVAL SUCCTION CUP WITH CLEATS

- Suitable for flat and rough surfaces.
- Fair stability and little inherent movement.
- Recommended when the lifting force is parallel to the surface of the object.
- Cleats prevent thin, sensitive objects from being deformed and give extra friction when the lifting force is parallel to the surface of the object.
- DURAFLEX® are suction cups manufactured in a specially developed material that features the elasticity of rubber and wear resistance of polyurethane. The material does not leave any marks on the objects handled.

### LIFTING FORCES & TECHNICAL DATA

Lifting force vertical to the surface, N, at vacuum level			Lifting force parallel to the surface, N, at vacuum level			Volume	Min. curve radius	Max. vertical movement	Weight with fitting
20 -kPa	60 -kPa	90 -kPa	20 -kPa	60 -kPa	90 -kPa	cm <sup>3</sup>	mm	mm	g
4.0	11.0	17.0	6.0	12.0	17.0	0.5	15.0	1.0	4.0

### MATERIAL SPECIFICATIONS

Material	Colour	Hardness °Shore A	Temperature range °C
Polyurethane, PU50	Blue transparent	50	10-50

### MATERIAL RESISTANCE

Wear resistance	Oil	Weather & ozone	Hydrolysis	Petrol	Concentrated acids	Ethanol	Methanol	Oxidation
Excellent	Excellent	Excellent	Fair**	Fair	Fair**	Fair	Poor	Poor

\*\*Please contact PIAB.

### ORDERING INFORMATION

Complete suction cups	Art. No.
Suction cup OF10x30P Polyurethane 50, M5 male	0110084

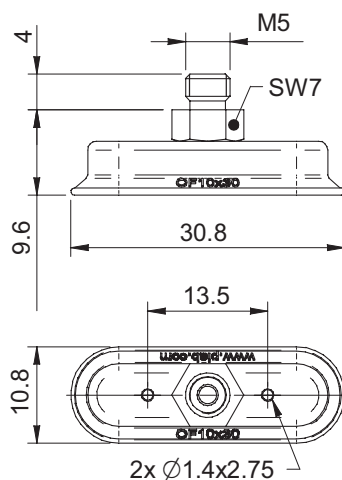

## OF15X45P



### FLAT, OVAL SUCCTION CUP WITH CLEATS

- ▶ Suitable for flat and rough surfaces.
- ▶ Fair stability and little inherent movement.
- ▶ Recommended when the lifting force is parallel to the surface of the object.
- ▶ Cleats prevent thin, sensitive objects from being deformed and give extra friction when the lifting force is parallel to the surface of the object.
- ▶ DURAFLEX® are suction cups manufactured in a specially developed material that features the elasticity of rubber and wear resistance of polyurethane. The material does not leave any marks on the objects handled.

### LIFTING FORCES & TECHNICAL DATA

Lifting force vertical to the surface, N, at vacuum level			Lifting force parallel to the surface, N, at vacuum level			Volume	Min. curve radius	Max. vertical movement	Weight with fitting
20 -kPa	60 -kPa	90 -kPa	20 -kPa	60 -kPa	90 -kPa	cm <sup>3</sup>	mm	mm	g
9.0	27	41	6.0	20.0	34	1.0	30	1.0	5.0

### MATERIAL SPECIFICATIONS

Material	Colour	Hardness °Shore A	Temperature range °C
Polyurethane, PU50	Blue transparent	50	10-50

### MATERIAL RESISTANCE

Wear resistance	Oil	Weather & ozone	Hydrolysis	Petrol	Concentrated acids	Ethanol	Methanol	Oxidation
Excellent	Excellent	Excellent	Fair**	Fair	Fair**	Fair	Poor	Poor

\*\*Please contact PIAB.

### ORDERING INFORMATION

Complete suction cups	Art. No.
Suction cup OF15x45P Polyurethane 50, G1/8" male	0110085

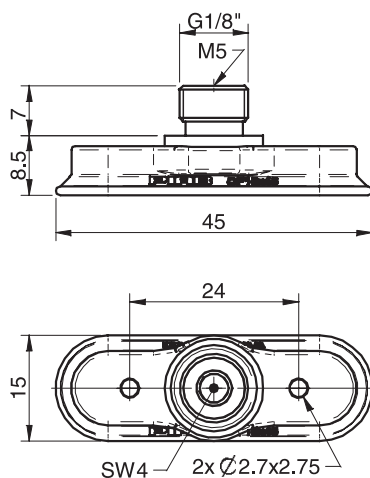

## OF25X70P



### FLAT, OVAL SUCCTION CUP WITH CLEATS

- Suitable for flat and rough surfaces.
- Fair stability and little inherent movement.
- Recommended when the lifting force is parallel to the surface of the object.
- Cleats prevent thin, sensitive objects from being deformed and give extra friction when the lifting force is parallel to the surface of the object.
- DURAFLEX® are suction cups manufactured in a specially developed material that features the elasticity of rubber and wear resistance of polyurethane. The material does not leave any marks on the objects handled.

### LIFTING FORCES & TECHNICAL DATA

Material	Lifting force vertical to the surface, N, at vacuum level			Lifting force parallel to the surface, N, at vacuum level			Volume cm <sup>3</sup>	Min. curve radius mm	Max. vertical movement mm	Weight with fitting g
	20 -kPa	60 -kPa	90 -kPa	20 -kPa	60 -kPa	90 -kPa				
PU40°	24.0	66	107	46	90	105	6.0	50	1.9	19
PU60°	24.0	77	118	42	127	161	6.0	50	1.9	19

### MATERIAL SPECIFICATIONS

Material	Color	Hardness °Shore A	Temperature range °C
Polyurethane, PU40	Red transparent	40	10–50
Polyurethane, PU60	Green transparent	60	10–50

### MATERIAL RESISTANCE

Wear resistance	Oil	Weather & ozone	Hydrolysis	Petrol	Concentrated acids	Ethanol	Methanol	Oxidation
Excellent	Excellent	Excellent	Fair**	Fair	Fair**	Fair	Poor	Poor

\*\*Please contact PIAB.

### ORDERING INFORMATION

Complete suction cups	Art. No.
Suction cup OF25x70P Polyurethane 60, G3/8" male - 1/8" NPSF female	0110086
Suction cup OF25x70P Polyurethane 40, G3/8" male - 1/8" NPSF female	0110087

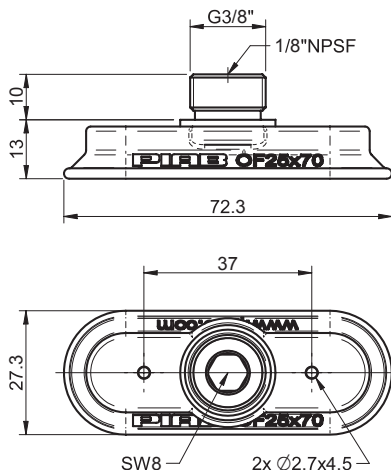

## OF40X110P



### FLAT, OVAL SUCCTION CUP WITH CLEATS

- Suitable for flat and rough surfaces.
- Fair stability and little inherent movement.
- Recommended when the lifting force is parallel to the surface of the object.
- Cleats prevent thin, sensitive objects from being deformed and give extra friction when the lifting force is parallel to the surface of the object.
- DURAFLEX® are suction cups manufactured in a specially developed material that features the elasticity of rubber and wear resistance of polyurethane. The material is mark-free.

### LIFTING FORCES & TECHNICAL DATA

Material	Lifting force vertical to the surface, N, at vacuum level			Lifting force parallel to the surface, N, at vacuum level			Volume cm <sup>3</sup>	Min. curve radius mm	Max. vertical movement mm	Weight rubber part g
	20 -kPa	60 -kPa	90 -kPa	20 -kPa	60 -kPa	90 -kPa				
PU40°	69	203	293	120	230	296	21.0	77	3.1	48
PU60°	74	200	303	98	228	410	21.0	77	3.1	48

### MATERIAL SPECIFICATIONS

Material	Color	Hardness °Shore A	Temperature range °C
Polyurethane, PU40	Red transparent	40	10-50
Polyurethane, PU60	Green transparent	60	10-50

### MATERIAL RESISTANCE

Wear resistance	Oil	Weather & ozone	Hydrolysis	Petrol	Concentrated acids	Ethanol	Methanol	Oxidation
Excellent	Excellent	Excellent	Fair**	Fair	Fair**	Fair	Poor	Poor

\*\*Please contact PIAB.

### ORDERING INFORMATION

Complete suction cups		Art. No.
A	Suction cup OF40x110P Polyurethane 40, 3/8"NPSF female	0109851
B	Suction cup OF40x110P Polyurethane 40, thread insert G3/8" male, with mesh filter	0109850
A	Suction cup OF40x110P Polyurethane 60, 3/8"NPSF female	0108265
B	Suction cup OF40x110P Polyurethane 60, thread insert G3/8" male, with mesh filter	0108263

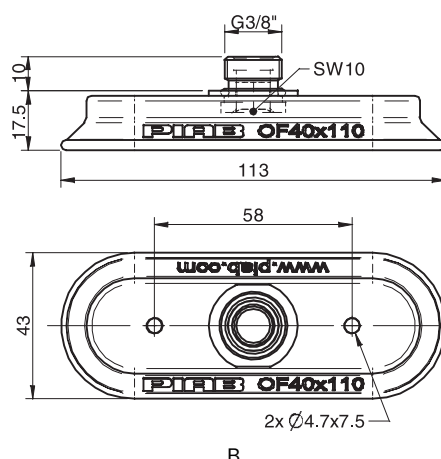
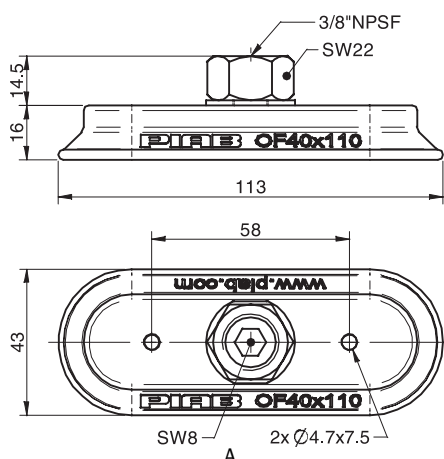

Rubber parts		Art. No.
Suction cup OF40x110P Polyurethane 40		0109907
Suction cup OF40x110P Polyurethane 60		0109906

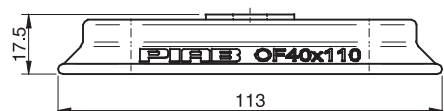

Fittings		Art. No.
Thread insert G3/8" male, with O-ring and mesh filter		0107148

## OF55X150P



### FLAT, OVAL SUCTION CUP WITH CLEATS

- ▶ Suitable for flat and rough surfaces.
- ▶ Fair stability and little inherent movement.
- ▶ Recommended when the lifting force is parallel to the surface of the object.
- ▶ Cleats prevent thin, sensitive objects from being deformed and give extra friction when the lifting force is parallel to the surface of the object.
- ▶ DURAFLEX® are suction cups manufactured in a specially developed material that features the elasticity of rubber and wear resistance of polyurethane. The material does not leave any marks on the objects handled.

### LIFTING FORCES & TECHNICAL DATA

Material	Lifting force vertical to the surface, N, at vacuum level			Lifting force parallel to the surface, N, at vacuum level			Volume cm <sup>3</sup>	Min. curve radius mm	Max. vertical movement mm	Weight rubber part g
	20 -kPa	60 -kPa	90 -kPa	20 -kPa	60 -kPa	90 -kPa				
PU40°	131	366	527	155	350	455	37	150	3.0	109
PU60°	134	376	558	128	338	477	37	150	3.0	109

### MATERIAL SPECIFICATIONS

Material	Color	Hardness °Shore A	Temperature range °C
Polyurethane, PU40	Red transparent	40	10–50
Polyurethane, PU60	Green transparent	60	10–50

### MATERIAL RESISTANCE

Wear resistance	Oil	Weather & ozone	Hydrolysis	Petrol	Concentrated acids	Ethanol	Methanol	Oxidation
Excellent	Excellent	Excellent	Fair**	Fair	Fair**	Fair	Poor	Poor

\*\*Please contact PIAB.

## ORDERING INFORMATION

	Complete suction cups	Art. No.
A	Suction cup OF55x150P Polyurethane 40, 3/8"NPSF female	0109853
B	Suction cup OF55x150P Polyurethane 40, thread insert G3/8" male, with mesh filter	0109852
A	Suction cup OF55x150P Polyurethane 60, 3/8"NPSF female	0108036
B	Suction cup OF55x150P Polyurethane 60, thread insert G3/8" male, with mesh filter	0108030

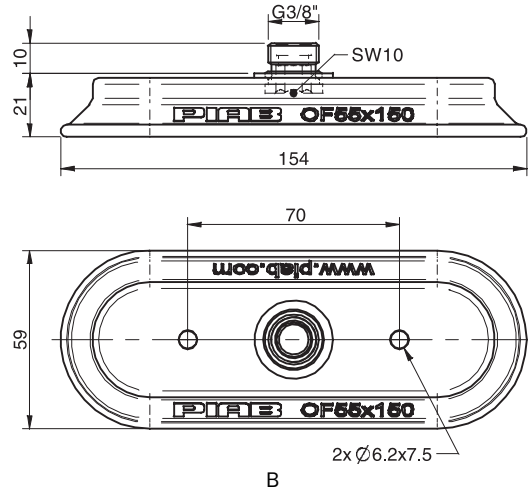
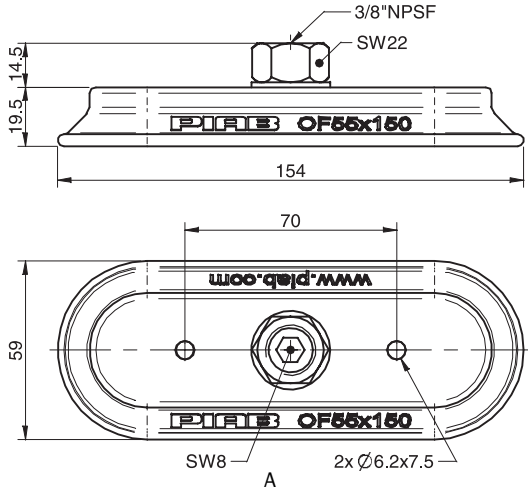

	Rubber parts	Art. No.
	Suction cup OF55x150P Polyurethane 40	0109909
	Suction cup OF55x150P Polyurethane 60	0109908

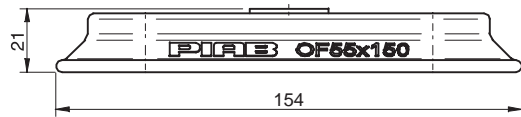

	Fittings	Art. No.
	Thread insert G3/8" male, with O-ring and mesh filter	0107148

## OF70X175P



### FLAT, OVAL SUCTION CUP WITH CLEATS

- ▶ Suitable for flat and rough surfaces.
- ▶ Fair stability and little inherent movement.
- ▶ Recommended when the lifting force is parallel to the surface of the object.
- ▶ Cleats prevent thin, sensitive objects from being deformed and give extra friction when the lifting force is parallel to the surface of the object.
- ▶ DURAFLEX® are suction cups manufactured in a specially developed material that features the elasticity of rubber and wear resistance of polyurethane. The material does not leave any marks on the objects handled.

### LIFTING FORCES & TECHNICAL DATA

Material	Lifting force vertical to the surface, N, at vacuum level			Lifting force parallel to the surface, N, at vacuum level			Volume cm <sup>3</sup>	Min. curve radius mm	Max. vertical movement mm	Weight rubber part g
	20 -kPa	60 -kPa	90 -kPa	20 -kPa	60 -kPa	90 -kPa				
PU40°	190	530	785	170	440	630	80	130	5.7	193
PU60°	180	570	860	200	555	750	80	130	5.7	193

### MATERIAL SPECIFICATIONS

Material	Color	Hardness °Shore A	Temperature range °C
Polyurethane, PU40	Red transparent	40	10–50
Polyurethane, PU60	Green transparent	60	10–50

### MATERIAL RESISTANCE

Wear resistance	Oil	Weather & ozone	Hydrolysis	Petrol	Concentrated acids	Ethanol	Methanol	Oxidation
Excellent	Excellent	Excellent	Fair**	Fair	Fair**	Fair	Poor	Poor

\*\*Please contact PIAB.



ORDERING INFORMATION

	Complete suction cups	Art. No.
A	Suction cup OF70x175P Polyurethane 40, 3/8"NPSF female	0109855
B	Suction cup OF70x175P Polyurethane 40, thread insert G3/8" male, with mesh filter	0109854
A	Suction cup OF70x175P Polyurethane 60, 3/8"NPSF female	0108264
B	Suction cup OF70x175P Polyurethane 60, thread insert G3/8" male, with mesh filter	0108671

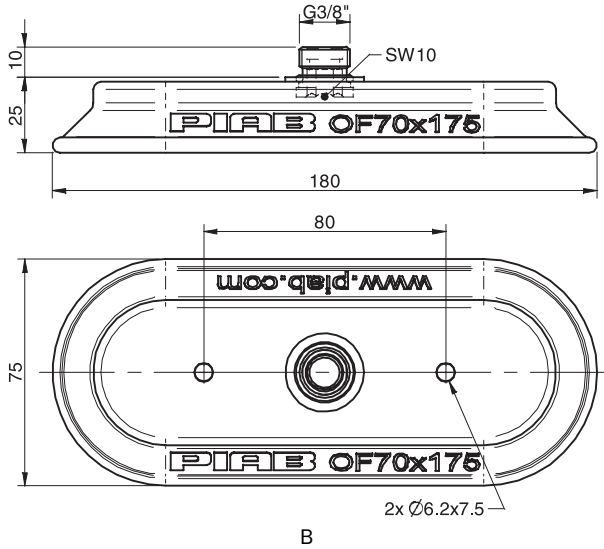
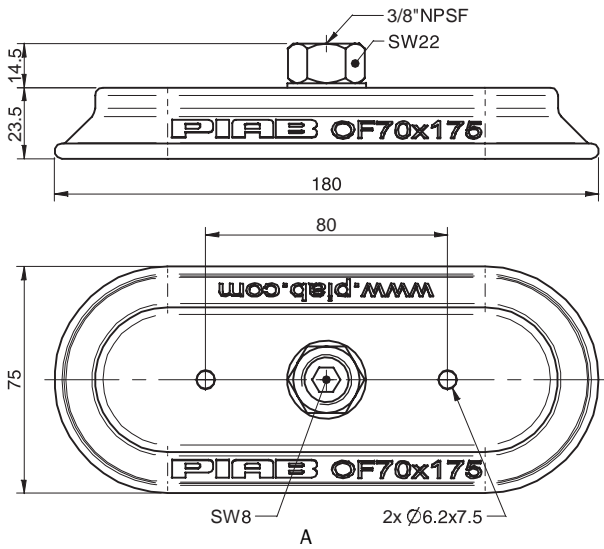

	Rubber parts	Art. No.
	Suction cup OF70x175P Polyurethane 40	0109911
	Suction cup OF70x175P Polyurethane 60	0109910

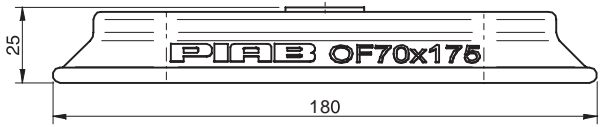

	Fittings	Art. No.
	Thread insert G3/8" male, with O-ring and mesh filter	0107148

## OP20X100



### OVAL SUCTION CUP WITH CELLULAR RUBBER PROFILE

- Suitable for handling oblong objects or thin pieces with uneven and rough surfaces.
- Use a ball joint fitting if prone to bending.

### LIFTING FORCES & TECHNICAL DATA

Lifting force vertical to the surface, N, at vacuum level			Lifting force parallel to the surface, N, at vacuum level			Volume	Min. curve radius	Max. vertical movement	Weight with fitting
20 -kPa	60 -kPa	90 -kPa	20 -kPa	60 -kPa	90 -kPa	cm <sup>3</sup>	mm	mm	g
25	80	110	—	—	—	14.0	—	1.5	87

### MATERIAL SPECIFICATIONS

Material	Colour	Hardness °Shore A	Temperature range °C
Ethylene propylene, EPDM	Grey	—	-40–100

### MATERIAL RESISTANCE

Wear resistance	Oil	Weather & Ozone	Hydrolysis	Petrol	Concentrated acids	Alcohol	Oxidation
Fair	Poor	Excellent	Good	Poor	Poor	Excellent	Excellent

### ORDERING INFORMATION

Complete suction cups	Art. No.
Suction cup OP20x100 Ethylene propylene, 1/8"NPSF female	3350050

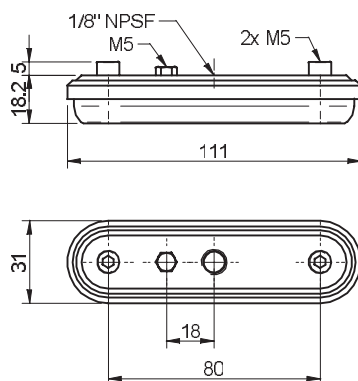

Rubber parts	Art. No.
Suction cup OP20x100 Ethylene propylene	3350028



Fittings	Art. No.
Fitting 1/8"NPSF female	3350061

## OP40X200



### OVAL SUCTION CUP WITH CELLULAR RUBBER PROFILE

- Suitable for handling oblong objects or thin pieces with uneven and rough surfaces.
- Use a ball joint fitting if prone to bending.

### LIFTING FORCES & TECHNICAL DATA

Lifting force vertical to the surface, N, at vacuum level			Lifting force parallel to the surface, N, at vacuum level			Volume	Min. curve radius	Max. vertical movement	Weight with fitting
20 -kPa	60 -kPa	90 -kPa	20 -kPa	60 -kPa	90 -kPa	cm <sup>3</sup>	mm	mm	g
100	320	440	—	—	—	56	—	2.5	326

### MATERIAL SPECIFICATIONS

Material	Colour	Hardness °Shore A	Temperature range °C
Ethylene propylene, EPDM	Grey	—	-40–100

### MATERIAL RESISTANCE

Wear resistance	Oil	Weather & Ozone	Hydrolysis	Petrol	Concentrated acids	Alcohol	Oxidation
Fair	Poor	Excellent	Good	Poor	Poor	Excellent	Excellent

### ORDERING INFORMATION

Complete suction cups	Art. No.
Suction cup OP40x200 Ethylene propylene, G1/2" female	3350051

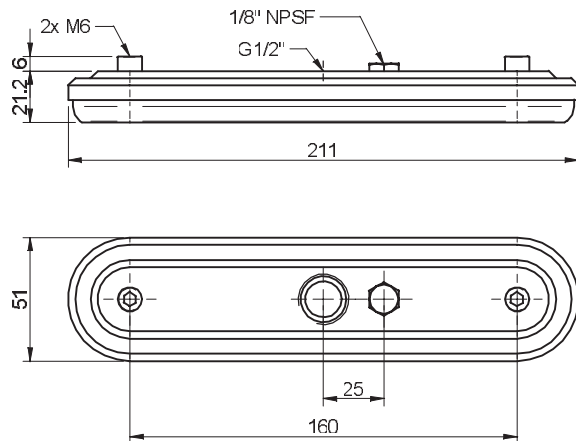

Rubber parts	Art. No.
Suction cup OP40x200 Ethylene propylene	3350029

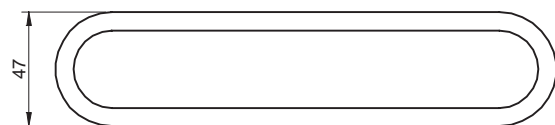
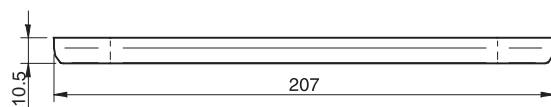

Fittings	Art. No.
Fitting G1/2" female	3350062